

LAFERRIERE, MICHAEL
 LAFERRIERE, SUSAN
 325 GARLAND ROAD
 DEXTER ME 04930
 USA
 B13905P275

Previous Owner
 NELSON, ROGER G. & CARMEN M.
 MICHAEL & SUSAN LAFERRIERE (GREENHOUSE)
 30 ARBOR DRIVE
 VEAZIE ME 04401
 Sale Date: 7/21/2015

Inspection Witnessed By:

X Date

No./Date	Description	Date Insp.

Notes:

Dexter

Property Data			Assessment Record						
Neighborhood 4 COMMERCIAL: RT7			Year	Land	Buildings	Exempt	Total		
Tree Growth Year 0			2009	10,400	79,700	0	90,100		
X Coordinate 0			2010	10,400	79,700	0	90,100		
Y Coordinate 0			2011	10,400	79,700	0	90,100		
Zone/Land Use 13 COMMERCIAL			2012	10,400	79,700	0	90,100		
Secondary Zone			2013	10,400	79,700	0	90,100		
Topography 2 Rolling			2014	10,400	71,700	0	82,100		
1.Level 4.Below St 7.LevelBog			2015	10,400	71,700	0	82,100		
2.Rolling 5.Low 8.			2016	10,400	92,700	0	103,100		
3.Above St 6.Swampy 9.			2017	10,400	74,200	0	84,600		
Utilities 1 All Public			2018	10,400	74,200	0	84,600		
1.Public 4.Dr Well 7.Cesspool			2019	10,400	74,200	0	84,600		
2.Water 5.Dug Well/L 8.			2020	10,400	74,200	0	84,600		
3.Sewer 6.Septic 9.None			2021	10,400	74,200	0	84,600		
Street 1 Paved			2022	10,400	74,200	0	84,600		
1.Paved 4.Proposed 7.			Land Data						
2.Semi Imp 5.R/O/W 8.									
3.Gravel 6. 9.None			Front Foot	Type	Effective		Influence		Influence Codes
TG PLAN YEAR 0			11.Regular Lot		Frontage	Depth	Factor	Code	
Tif District # 0			12.Delta Triangle				%		1.Unimproved
Sale Data			13.Nabla Triangle				%		2.Excess Frtg
Sale Date 7/21/2015			14.Rear Land				%		3.Topography
Price 125,000			15.Miscellaneous				%		4.Size/Shape
Sale Type 2 Land & Buildings							%		5.Access
1.Land 4.Mobile 7.C/I L&B			Square Foot	Square Feet					6.Restriction
2.L & B 5.Other 8.			16.Regular Lot				%		7.Open Space
3.Building 6.C/I Land 9.			17.Secondary Lot				%		8.View/Environ
Financing 9 Unknown			18.Hydro Facility				%		9.Fract Share
1.Convent 4.Seller 7.FORE			19.Improvements				%		Acres
2.FHA/VA 5.Private 8.			20.Miscellaneous				%		30.REAR LAND 21+
3.Assumed 6.Cash 9.Unknown							%		31.FARM FORAGE
Validity 1 Arms Length Sale			Fract. Acre	Acres/Sites					32.FARM CROPLAND/
1.Valid 4.Split 7.Renovate			21.Homesite (Fract)	48	0.12	100	%	0	33.Horticulture
2.Related 5.Partial 8.Other			22.Basemat (Fract)				%		34.Softwood F&O
3.Distress 6.Exempt 9.			23.Misc (Fract)				%		35.Mixed Wood F&O
Verified 5 Public Record			Acres				%		36.Hardwood F&O
1.Buyer 4.Agent 7.Family			24.Homesite				%		37.Softwood TG
2.Seller 5.Pub Rec 8.Other			25.Basemat				%		38.Mixed Wood TG
3.Lender 6.MLS 9.			26.Frontage 1				%		39.Hardwood TG
			27.Frontage 2				%		40.WASTELAND
			28.REAR LAND 1-10				%		41.Open Space
			29.REAR LAND 11-2				%		42.Mobile Home Si
			Total Acreage		0.12				43.Condo Site
									44.Lot Improvemen
									45.Subdivision Lo
									46.Golf Course

Dexter

Map Lot 017-001

Account 1149

Location 325 GARLAND ROAD

Card 1 Of 1 11/07/2022

Occupancy Code	37 Retail Store	1 Apartments
No. of Dwelling Units	0	1
Building Class/Quality	4 Wood Frame	4 Wood Frame
1.Steel	1.Low Cost	1 Low Cost
2.Rein Conc	2.Average	
3.Masonry	3.Good	
4.Wood Frm	4.Excellent	
5.Rigid Frm		
Grade Factor	1.00	1.00
Exterior Walls	6 Composition	0
1.Br/St	6.Compos	
2.C Block	7.Al/Vinyl	
3.Concrete	8.Steel	
4.Wood	9.Other	
5.Stucco		
Stories/Height	1 8	1 8
Ground Floor Area	1,940	600
Perimeter Units/FI	214	1
Heating/Cooling	14 Hot Water	14 Hot Water
11.Elec BB	19.Wall/FI	
12.Wall	20.Heat/Co	
13.FWA	21.Package	
14.HW	22.W/C Air	
15.Space	23.H/C Wat	
16.Steam w	24.HeatPum	
17.Steam N	25.Indiv H	
18.Vent	26.	
Year Built	1920	1970
Year Remodeled	1970	0
Condition	4 Average	4 Average
1.Poor	6.Good	
2.Fair	7.Very Good	
3.Below Ave	8.Excellent	
4.Average	9.Same	
5.Above Ave		
Physical % Good	0	0
Functional % Good	100	100
Economic % Good		75



TRIO
Software
A Division of Harris Computer Systems

Entrance Code	
1.Interior	6.
2.Refusal	7.
3.Informed	8.
4.Vacant	9.
5.Estimate	
Information Code	
1.Owner	6.Other
2.Relative	7.
3.Tenant	8.
4.Agent	9.
5.Estimate	

M/S CLASS D LOW COST RETAIL

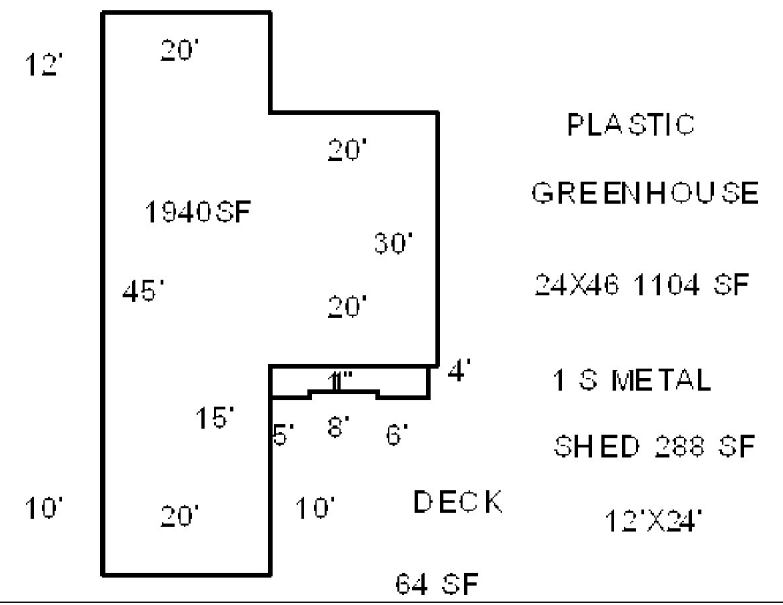

Date Inspected 6/28/2011

Additions, Outbuildings & Improvements

Type	Year	Units	Grade	Cond	Phys.	Func.	Sound Value
68 Wood Deck	1970	64	3 100	4	0 %	100 %	
174 Poly	1995	1392	2 100	2	0 %	100 %	
					%	%	
					%	%	
					%	%	
					%	%	
					%	%	
					%	%	
					%	%	
					%	%	
					%	%	
					%	%	
					%	%	
					%	%	
					%	%	
					%	%	
					%	%	
					%	%	
					%	%	
					%	%	
					%	%	

- 1.One Story Fram
- 2.Two Story Fram
- 3.Three Story Fr
- 4.1 & 1/2 Story
- 5.1 & 3/4 Story
- 6.2 & 1/2 Story
- 21.Open Frame Por
- 22.Encl Frame Por
- 23.Frame Garage
- 24.Frame Shed
- 25.Frame Bay Wind
- 26.1SFr Overhang
- 27.Unfin Basement
- 28.Unfinished Att
- 29.Finished Attic

VALLEY, DEBORAH J
101 WEST PLEASANT STREET
WESTBROOK ME 04092

B9149P48

Inspection Witnessed By:

No./Date	Description	Date Insp.
X		

Notes:

Dexter

Property Data			Assessment Record				
Neighborhood 68 CORINNA RD			Year	Land	Buildings	Exempt	Total
Tree Growth Year 0			2009	15,700	0	0	15,700
X Coordinate 0			2010	15,700	0	0	15,700
Y Coordinate 0			2011	15,700	0	0	15,700
Zone/Land Use 11 RURAL			2012	15,700	0	0	15,700
Secondary Zone			2013	15,700	0	0	15,700
Topography 2 Rolling			2014	15,700	0	0	15,700
1.Level 4.Below St 7.LevelBog			2015	15,700	0	0	15,700
2.Rolling 5.Low 8.			2016	15,700	0	0	15,700
3.Above St 6.Swampy 9.			2017	15,700	0	0	15,700
Utilities			2018	15,700	0	0	15,700
1.Public 4.Dr Well 7.Cesspool			2019	15,700	0	0	15,700
2.Water 5.Dug Well/L 8.			2020	15,700	0	0	15,700
3.Sewer 6.Septic 9.None			2021	15,700	0	0	15,700
Street 1 Paved			2022	15,700	0	0	15,700
1.Paved 4.Proposed 7.			Land Data				
2.Semi Imp 5.R/O/W 8.							
3.Gravel 6. 9.None			Front Foot				
TG PLAN YEAR 0							
Tif District # 0			Square Foot				
Sale Data							
Sale Date			Fract. Acre				
Price							
Sale Type			Acres				
1.Land 4.Mobile 7.C/I L&B							
2.L & B 5.Other 8.			Fract. Acre				
3.Building 6.C/I Land 9.							
Financing			Acres				
1.Convent 4.Seller 7.FORE							
2.FHA/VA 5.Private 8.			Fract. Acre				
3.Assumed 6.Cash 9.Unknown							
Validity			Acres				
1.Valid 4.Split 7.Renovate							
2.Related 5.Partial 8.Other			Fract. Acre				
3.Distress 6.Exempt 9.							
Verified			Acres				
1.Buyer 4.Agent 7.Family							
2.Seller 5.Pub Rec 8.Other			Fract. Acre				
3.Lender 6.MLS 9.							

Type	Effective		Influence		Influence Codes
	Frontage	Depth	Factor	Code	
11.Regular Lot			%		1.Unimproved
12.Delta Triangle			%		2.Excess Frtg
13.Nabla Triangle			%		3.Topography
14.Rear Land			%		4.Size/Shape
15.Miscellaneous			%		5.Access
			%		6.Restriction
			%		7.Open Space
			%		8.View/Environ
			%		9.Fract Share
			%		Acres
			%		30.REAR LAND 21+
			%		31.FARM FORAGE
			%		32.FARM CROPLAND/
			%		33.Horticulture
			%		34.Softwood F&O
			%		35.Mixed Wood F&O
			%		36.Hardwood F&O
			%		37.Softwood TG
			%		38.Mixed Wood TG
			%		39.Hardwood TG
			%		40.WASTELAND
			%		41.Open Space
			%		42.Mobile Home Si
			%		43.Condo Site
			%		44.Lot Improvemen
			%		45.Subdivision Lo
			%		46.Golf Course
Total Acreage			8.50		

Dexter

Map Lot 017-002

Account 1150

Location CORINNA ROAD

Card 1 Of 1 11/07/2022

Building Style			SF Bsmt Living			Layout								
0.Not Code	4.Cape	8.Log	Fin Bsmt Grade			1.Typical	4.	7.						
1.Conv.	5.Garrison	9.DW	OPEN 5 OPTIONAL			2.Inadeq	5.	8.						
2.Ranch	6.Split	10.Seasona	Heat Type 100%			3.Poor	6.	9.						
3.R Ranch	7.Contemp	11.Primiti	0.Not Code	4.Steam	8.Fi/Wall	Attic								
Dwelling Units			1.HWBB	5.FWA	9.No Heat	1.1/4 Fin	4.Full Fin	7.						
Other Units			2.HWCI	6.GravWA	11.	2.1/2 Fin	5.Fi/Stair	8.						
Stories			3.H Pump	7.Electric	12.	3.3/4 Fin	6.	9.None						
1.1	4.1.5	7.	Cool Type 0%			Insulation								
2.2	5.1.75	8.	1.CENTRAL	4.NONE	7.	1.Full	4.Minimal	7.						
3.3	6.2.5	9.	2.NONE	5.	8.	2.Heavy	5.	8.						
Exterior Walls			3.NONE	6.	9.None	3.Capped	6.	9.None						
0.Not Code	4.Asbestos	8.AL/Vinyl	Kitchen Style			Unfinished %								
1.Clapboar	5.T-111	9.Other	1.Modern	4.Obsolete	7.	Grade & Factor								
2.WD. SH.	6.BR/Stone	10.Log Sid	2.Typical	5.	8.	1.E Grade	4.B Grade	7.AA GRADE						
3.Compos.	7.Novelty	12.	3.Old Type	6.	9.None	2.D Grade	5.A Grade	8.AAA GRAD						
Roof Surface			Bath(s) Style			3.C Grade	6.A PLUS G	9.Same						
1.Asphalt	4.Composit	7.ARK SHIN	1.Modern	4.Obsolete	7.	SQFT (Footprint)								
2.Slate	5.Wood	8.Seamless	2.Typical	5.	8.	Condition								
3.Metal	6.Other	9.	3.Old Type	6.	9.None	1.Poor	4.Avg	7.V G						
SF Masonry Trim			# Rooms			2.Fair	5.Avg+	8.Exc						
OPEN-3-CUSTOM			# Bedrooms			3.Avg-	6.Good	9.Same						
OPEN-4-CUSTOM			# Full Baths			Phys. % Good								
Year Built			# Half Baths			Funct. % Good								
Year Remodeled			# Addn Fixtures			Functional Code								
Foundation			# Fireplaces			1.Incomp	4.SMALL	7.LAYOUT						
1.Concrete	4.Wood	7.							2.O-Built	5.CDU	8.OTHER			
2.C Block	5.Slab	8.							Econ. % Good			3.DELAP	6.STYLE	9.None
3.Br/Stone	6.Piers	9.							Economic Code			0.None 3.No Power 6.Traffic		
Basement									0.None 3.No Power 6.Traffic			1.Location 4.Generate 7.Apt		
1.1/4 Bmt	4.Full Bmt	7.							1.Location 4.Generate 7.Apt			2.Encroach 5.Services 8.OTHER		
2.1/2 Bmt	5.None	8.							2.Encroach 5.Services 8.OTHER			Entrance Code 0		
3.3/4 Bmt	6.DAYLIGHT	9.None							Entrance Code 0			1.Interior 4.Vacant 7.		
Bsmt Gar # Cars									1.Interior 4.Vacant 7.			2.Refusal 5.Estimate 8.		
Wet Basement									2.Refusal 5.Estimate 8.			3.Informed 6. 9.		
1.Dry	4.	7.							Information Code 0			1.Owner 4.Agent 7.		
2.Damp	5.	8.	1.Owner 4.Agent 7.			2.Relative 5.Estimate 8.								
3.Wet	6.	9.	2.Relative 5.Estimate 8.			3.Tenant 6.Other 9.								
Date Inspected			3.Tenant 6.Other 9.											

Additions, Outbuildings & Improvements								1.One Story Fram
Type	Year	Units	Grade	Cond	Phys.	Funct.	Sound Value	2.Two Story Fram
					%	%		3.Three Story Fr
					%	%		4.1 & 1/2 Story
					%	%		5.1 & 3/4 Story
					%	%		6.2 & 1/2 Story
					%	%		21.Open Frame Por
					%	%		22.Encl Frame Por
					%	%		23.Frame Garage
					%	%		24.Frame Shed
					%	%		25.Frame Bay Wind
					%	%		26.1SFr Overhang
					%	%		27.Unfin Basement
					%	%		28.Unfinished Att
					%	%		29.Finished Attic

Dexter

Map Lot 017-003

Account 1151

Location SPRING STREET

Card 1 Of 1 11/07/2022

Building Style			SF Bsmt Living			Layout								
0.Not Code	4.Cape	8.Log	Fin Bsmt Grade			1.Typical	4.	7.						
1.Conv.	5.Garrison	9.DW	OPEN 5 OPTIONAL			2.Inadeq	5.	8.						
2.Ranch	6.Split	10.Seasona	Heat Type 100%			3.Poor	6.	9.						
3.R Ranch	7.Contemp	11.Primiti	0.Not Code	4.Steam	8.Fi/Wall	Attic								
Dwelling Units			1.HWBB	5.FWA	9.No Heat	1.1/4 Fin	4.Full Fin	7.						
Other Units			2.HWCI	6.GravWA	11.	2.1/2 Fin	5.Fi/Stair	8.						
Stories			3.H Pump	7.Electric	12.	3.3/4 Fin	6.	9.None						
1.1	4.1.5	7.	Cool Type 0%			Insulation								
2.2	5.1.75	8.	1.CENTRAL	4.NONE	7.	1.Full	4.Minimal	7.						
3.3	6.2.5	9.	2.NONE	5.	8.	2.Heavy	5.	8.						
Exterior Walls			3.NONE	6.	9.None	3.Capped	6.	9.None						
0.Not Code	4.Asbestos	8.AL/Vinyl	Kitchen Style			Unfinished %								
1.Clapboar	5.T-111	9.Other	1.Modern	4.Obsolete	7.	Grade & Factor								
2.WD. SH.	6.BR/Stone	10.Log Sid	2.Typical	5.	8.	1.E Grade	4.B Grade	7.AA GRADE						
3.Compos.	7.Novelty	12.	3.Old Type	6.	9.None	2.D Grade	5.A Grade	8.AAA GRAD						
Roof Surface			Bath(s) Style			3.C Grade	6.A PLUS G	9.Same						
1.Asphalt	4.Composit	7.ARK SHIN	1.Modern	4.Obsolete	7.	SQFT (Footprint)								
2.Slate	5.Wood	8.Seamless	2.Typical	5.	8.	Condition								
3.Metal	6.Other	9.	3.Old Type	6.	9.None	1.Poor	4.Avg	7.V G						
SF Masonry Trim			# Rooms			2.Fair	5.Avg+	8.Exc						
OPEN-3-CUSTOM			# Bedrooms			3.Avg-	6.Good	9.Same						
OPEN-4-CUSTOM			# Full Baths			Phys. % Good								
Year Built			# Half Baths			Funct. % Good								
Year Remodeled			# Addn Fixtures			Functional Code								
Foundation			# Fireplaces			1.Incomp	4.SMALL	7.LAYOUT						
1.Concrete	4.Wood	7.							2.O-Built	5.CDU	8.OTHER			
2.C Block	5.Slab	8.							Econ. % Good			3.DELAP	6.STYLE	9.None
3.Br/Stone	6.Piers	9.							Economic Code			0.None 3.No Power 6.Traffic		
Basement									0.None 3.No Power 6.Traffic			1.Location 4.Generate 7.Apt		
1.1/4 Bmt	4.Full Bmt	7.							1.Location 4.Generate 7.Apt			2.Encroach 5.Services 8.OTHER		
2.1/2 Bmt	5.None	8.							Entrance Code 0			1.Interior 4.Vacant 7.		
3.3/4 Bmt	6.DAYLIGHT	9.None							2.Refusal 5.Estimate 8.			3.Informed 6. 9.		
Bsmt Gar # Cars									Information Code 0			1.Owner 4.Agent 7.		
Wet Basement									2.Relative 5.Estimate 8.			3.Tenant 6.Other 9.		
1.Dry	4.	7.							3.Tenant 6.Other 9.					
2.Damp	5.	8.												
3.Wet	6.	9.												
Date Inspected														

Additions, Outbuildings & Improvements								1.One Story Fram
Type	Year	Units	Grade	Cond	Phys.	Funct.	Sound Value	2.Two Story Fram
					%	%		3.Three Story Fr
					%	%		4.1 & 1/2 Story
					%	%		5.1 & 3/4 Story
					%	%		6.2 & 1/2 Story
					%	%		21.Open Frame Por
					%	%		22.Encl Frame Por
					%	%		23.Frame Garage
					%	%		24.Frame Shed
					%	%		25.Frame Bay Wind
					%	%		26.1SFr Overhang
					%	%		27.Unfin Basement
					%	%		28.Unfinished Att
					%	%		29.Finished Attic